

## **Bushwhacker plus 17FD Travel Trailer.**

**Sleeps 3 or 4 (2 children), wet bath with stand up shower, a kitchen with 2-burner stove, 12-volt fridge, sink and microwave, a queen size bed and a dinette that will convert to a bed. Air Conditioner and Furnace with temperature control.**

**Towing - designed with 3000 lb high clearance, torsion-flex, independent axle for smooth towing.**

**Additional features added: storage for clothing, top of fridge, shelves bathroom for shampoo, soap and conditioner, increased size of Battery Box holds two batteries as well as tank holder is able to hold two tanks. Made a tube to store fishing rods or similar items. Tote-n-stor portable waste transporter. Sewage sidewinder provide support to sewage hoses. Chocks-10, ~~Radley Generator 2500 watt~~, 2 clip on mirrors for towing, 2 Jacks supporting trailer, storage tarp for covering during winter storage, outdoor carpet, ~~gerry can~~, water hose, electric cable for shore power.**

## BUSHHACKER PLUS SPECIFICATIONS

\*Always Check nearest Braxton's change specifications without notice or obligation.

MODEL	Exterior Length	Exterior Width	Exterior Height	Axle Height	Dry Weight	Dry Hitch Height	GVAW	Cargo Carrying Capacity	Fresh Water Capacity	Grey Waste Water Capacity	Black Waste Water Capacity	Sleeping Capacity
15DS	15'6"	6'9"	8'8"	TBD	TBD	TBD	TBD	TBD	TBD	TBD	TBD	2
15FK	15'6"	6'9"	8'8"	1840	1900	250	3200	1105	21	10	8	2
17BH	18'	6'9"	8'8"	2040	2360	330	3320	760	24	10	17	4
17FD	18'	6'9"	8'8"	1950	2240	280	3220	840	24	10	17	3

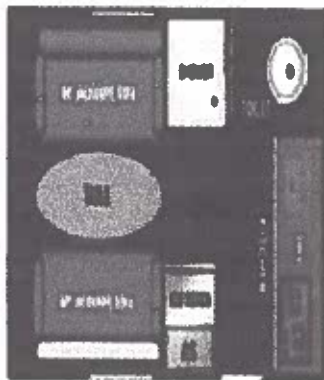

15DS

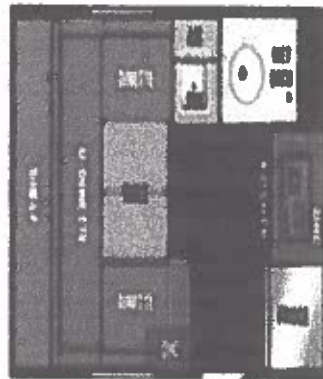

15FK

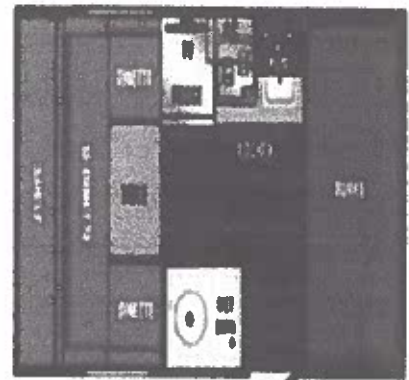

17BH

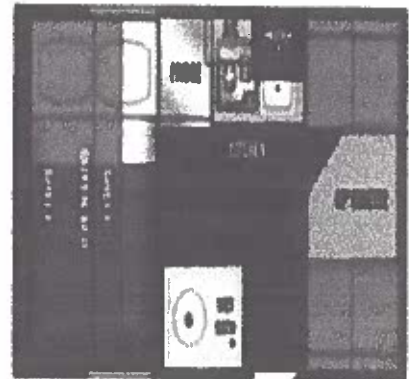

17FD



Member  
**RVIA**

**BRAXTON**  
RV